

Technical Data

Weight: 8 000 kg (without product and bead charge)
 Dynamic load of the floor: approx. 120 kN

Cooling water
 Requirement: max. 200 l/min
 Pressure: max. 300 kPa (3 bar)

Compressed air connection:
 min. 400 kPa (4 bar)
 max. 900 kPa (9 bar)

Sound pressure level: 85 dB(A)
 (★ measured under operating conditions, in a distance of 1 m to the machine, 1.6 m from the floor)

Sealing liquid leakage: max. 100 ml/h
 (on each sealing side)

Main dimensions:
 A = 2 600 mm
 B = 3 700 mm
 C = 1 550 mm
 D = 3 350 mm
 E = 1 360 mm

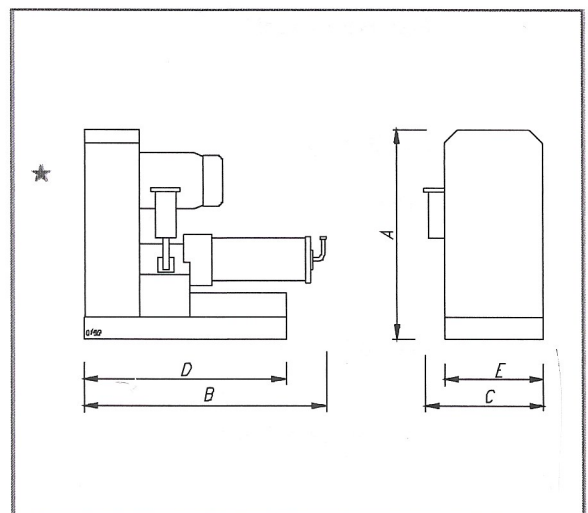

Volume of grinding chamber	approx. 530 litre
Volume of product to be ground	approx. 265 litre
Volume of grinding media 100%	488 litre
Grinding chamber	carriage-type
Grinding chamber design	steel
Outer shell	steel with finish
Inner jacket	exchangeable, with coils for intensive cooling
Inner pipe	steel
Agitator shaft	with 1 TriNEx grinding disc of chilled cast iron (GX 280), 9 NexWing-grinding discs of chilled cast iron, 9 intermediate rings of steel
Chamber bottom	of steel with 3" tri-clamp connections at outlet
Inlet flange	of steel with 3" tri-clamp connections at inlet
Separating system	Type DCC Dynamic Classifying Cartridge system Grinding media separation via a dynamic classifying cartridge system. In its protected area we arranged a large-dimensioned slotted pipe designed for highest throughput rates even with very small grinding media. Slotted pipe of stainless steel. Gap width 2.4 mm
Chamber sealing	by dual-acting mechanical seal and sealing liquid refilling unit with hand pump. Cassette-type mechanical seal with intensive sealing fluid circulation. Sealing fluid vessel with internal cooling coil. Level monitoring by sight glass and float switch. Temperature switch in the sealing liquid return line. Compressed air connection with filter, control valve and pressure switch.
Sealings	FKM/FKM - FDA
Material of sealing	product contact components: FKM-FDA product piping: PTFE cooling water contact components: FKM
Monitoring	-supplied by NPT-
Drive	Agitator drive speed infinitely variable by frequency converter (motor Exd) -supplied by NPT- Driven by belt drive from the motor to the drive shaft.
Main drive motor	Speed at 60 Hz = 350 prm -supplied by NPT- 250 HP, 60 Hz, 460 V, 3 phases, 1200 rpm
Electrical equipment	-supplied by NPT-